

Autostart AS710S/AS730S V1.05 – V1.09(a) Autostart AS705S V1.00 – V1.06(a) Installation Instructions Section B: Programming

mi5265
revision E, 12th Sept 2011
catalogue section 75



Please read the following information before installing. A visual inspection of this product for damage during shipping is recommended before installation. It is your responsibility to ensure that qualified mechanical and electrical technicians install this product. If in doubt, please contact your local Murphy representative.

WARNING

BEFORE BEGINNING INSTALLATION OF THIS MURPHY PRODUCT

- ✓ Disconnect all electrical power to the machine
- ✓ Make sure the machine cannot operate during installation
- ✓ Follow all safety warnings of the machine manufacturer
- ✓ Read and follow all installation instructions

Description

The Autostart AS7XX family of controls is designed to provide automatic or manual control of a standby diesel generator, pump or engine driven application.

The units in the range – the AS705S, AS710S and AS730S – share a number of common programmable features, including timers, trip levels, inputs, outputs and fault configurations.

This document details the programming of the AS7XX range. Further details on specification, installation and operation of the range can be found in the following documents:-

Doc. ref.	Title
ms5258	AS705S bulletin
mi5396	AS705S installation and wiring
ms5259	AS710S bulletin
mi5262	AS710S installation and wiring
ms5261	AS730S bulletin
mi5264	AS730S installation and wiring
mi5266	AS7xx communications and AS7CK PC software

The above are available on request from your Murphy representative, or from the products section of our website www.fwmurphy.co.uk

Programming

Each Autostart **MUST** be programmed before it can be tested or used to control an engine.



WARNING: Failure to correctly program each unit can result in damage to Autostart, engine and other equipment.

Programming is typically carried out after installation into the engine control panel, but may also be carried out 'on the bench' with a minimum power supply connection. The pages following list the program functions and options available, with an explanation for each, and the default factory settings.

Autostarts can be programmed in several ways, depending on the unit type:-

All units

Any AS7xx unit may be programmed by use of Murphy PC software model AS7CK. (Note: the AS705S can **ONLY** be programmed in this way.) The software allows Autostart program 'profiles' to be created, edited and stored on a desktop or laptop PC. These program profiles may be uploaded and downloaded between Autostart and PC over an RS232 communication link:-

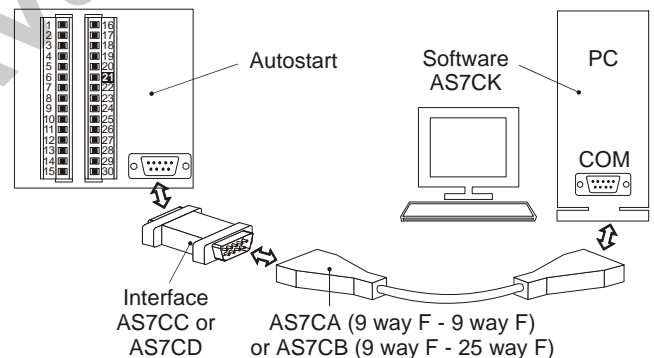

This method of programming is particularly suited to larger batches of Autostarts having the same program specification.

Full details about the installation and operation of software and communication links can be found in document mi5266.

FW MURPHY
P.O. Box 470248, Tulsa, Oklahoma 74147 USA
+1 918 317 4100 Fax: +1 918 317 4266
E-mail: sales@fwmurphy.com

INDUSTRIAL PANEL DIVISION
Fax: +1 918 317 4124
E-mail: ipdsales@fwmurphy.com

MURPHY POWER IGNITION
Website: www.murphy-pi.com

CONTROL SYSTEMS AND SERVICES DIVISION
P.O. Box 1819, Posenberg, Texas 77471 USA
Phone: +1 281 633 4500 Fax: +1 281 633 4588
E-mail: csssolutions@fwmurphy.com

FRANK W. MURPHY LTD.
Church Road, Laverstock,
Salisbury, SP1 1GZ, United Kingdom
Tel: +44 1722 410055

Fax: +44 1722 410088
E-mail: sales@fwmurphy.co.uk
Web: www.fwmurphy.co.uk

COMPUTRONIC CONTROLS
41 – 46 Railway Terrace, Netchells,
Birmingham, B7 5NG, United Kingdom
E-mail: sales@computroniccontrols.com
Web: www.computroniccontrols.com

FW MURPHY INSTRUMENTS (HANGZHOU) CO., LTD.
77 23rd Street, Hangzhou Economic & Technological Development Area
Hangzhou, Zhejiang, 310018, China
Phone: +86 571 8788 6060 Fax: +86 571 8684 8878
E-mail: apsales@fwmurphy.com



USA-ISO 9001:2008 FM 28221
UK-ISO 9001:2008 FM 29422
CHINA-ISO 9001:2008 FM 523851
Registered Facilities



AS730S

The AS730S front facia has a liquid crystal display (LCD) and push buttons, which may be used to step through and adjust each program option in turn.

To enter 'program mode':-

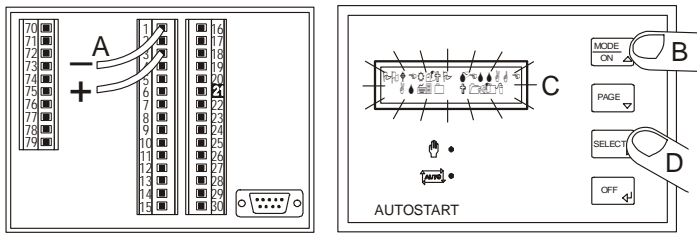

- Connect DC power to the AS730S: positive DC to pin 3, negative DC to pin 1. Other terminals may be left open circuit or connected as normal.
- Press and release the ON/MODE key (B). Immediately that the display lights (C), press and hold the SELECT key (D).
- If the AS730S displays 'Enter PIN (Personal Identification Number)', use the \triangleright , \triangle and ∇ keys (labelled in red) to change the display to the correct 4 figure PIN (the factory default is 1234), then press \blacktriangleleft . If the PIN is correctly entered (or if PIN entry is not requested), the AS730S displays the first program function ('start delay').

Programming each function:-

- Use the \triangle and ∇ keys (and the \triangleright key for text messages) to change the option or value displayed.
- When the correct setting is displayed, press \blacktriangleleft to confirm the value/option and move on to the next function. Full details of each programmable function are listed overleaf.

To exit program mode and save changes:-

- At the end of the program sequence, the AS730S displays 'exit program mode?'. To save the program changes, press the \blacktriangleleft key, wait a second or so, then press the OFF (\blacktriangleleft) key again when prompted. Alternatively, press the \triangleright , \triangle or ∇ keys to review the program settings again. If power is removed during the program sequence, the unit reverts to the previously held program settings.

AS710S

Programming the AS710S is similar in principle to the AS730S. The AS710S has a front facia LCD, but the program mode navigation keys are provided on a separate hand-held programmer keypad. The key-pad, model AS7PROG, is supplied separately from the AS710S, and is connected to the AS710S only when programming:-

To enter program mode:-

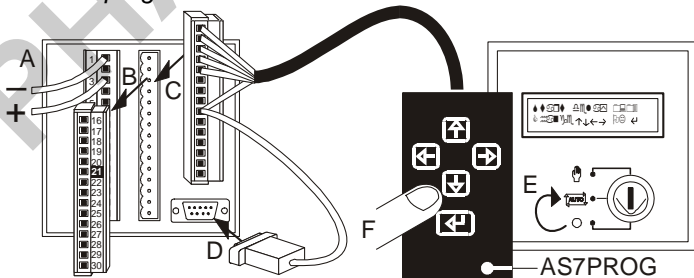

- Ensure that the AS710S is switched to O (Off/reset). Connect a power supply, 5 – 40 VDC: positive DC to pin 3, negative DC to pin 1 (A above).
- Remove terminal block 16 - 30 (B), and in its place connect the programming key-pad's 15 way terminal block (C)
- Connect the key-pad 'D' connector into the 9 way D-socket at the Autostart's rear (D above).
- Switch the Autostart to Auto mode (E).
- The display should momentarily read 'program mode'. If the displays then reads 'Enter PIN' (Personal Identification Number), use the \uparrow \downarrow \leftarrow and \rightarrow buttons to change the display to the correct PIN (the factory default PIN is 1234), then press \blacktriangleleft .
- Once the correct PIN is entered (or if PIN entry is not requested), Autostart displays the first programmable function ('Start delay').

To re-program each function:-

- Use the key-pad \uparrow and \downarrow buttons (and the \leftarrow and \rightarrow buttons for text messages) to change the option or value shown on the Autostart's display.
- When the correct setting is displayed, press \blacktriangleleft to confirm the value/option and move on to the next function. Full details of each programmable function are listed overleaf.

To exit program mode and save changes:-

- When 'exit program mode?' is displayed, press the \blacktriangleleft key, wait a second or two, then turn the key to \bigcirc (off/reset). Alternatively, press the \uparrow \downarrow \leftarrow or \rightarrow keys to review the program settings.
- Disconnect the hand-held programmer unit, then re-connect terminal block 16 - 30.

Note: at power up, the AS710S detects the connection of the program key-pad by looking at pin 28. If pin 28 is connected to negative DC, the unit operates normally. If pin 28 is left open circuit (as on the keypad connector), the unit attempts to enter 'program mode'. After disconnection of the key-pad, pin 28 must be reconnected (to negative DC, via a wire link or manual stop button) before normal operation can occur.

Program sequence

The following pages detail the program functions available on each unit. Feature availability for each unit type is given in the first three columns.

The functions are listed in the order of appearance when programming from the front facia (AS730S) or using a key-pad (AS710S). When programming from the PC software, the functions and options are identical, but are ordered differently on 6 screens, with each screen displaying several program options at once.

Programming Check Sheets

Customer/Engine/Site Name:.....

Autostart serial number:.....

Job ref.

Programmed by

Date:.....

AS705S	AS710S	AS730S	Function	Settings (tick as appropriate):		Description
				Default	New	
●	●	●	Start delay	<input type="checkbox"/> 0:02	<input type="checkbox"/> min sec	(0 – 10 mins) In Auto mode, this timer sets a delay between the occurrence of a remote start (pin 11 going open circuit) and the first engine start attempt.
●	●	●	Preheat	<input type="checkbox"/> 00 sec	<input type="checkbox"/> sec	(00 – 59 secs) If any of the programmable outputs (see sections below) have been programmed to give a 'preheat' function, that output will activate for this time period before each engine crank attempt.
●	●	●	Crank	<input type="checkbox"/> 10 sec	<input type="checkbox"/> sec	(03 – 59 secs) Sets the maximum time for each engine crank attempt.
●	●	●	Crnk cool	<input type="checkbox"/> 10 sec	<input type="checkbox"/> sec	(03 – 59 secs) Allows the batteries & starter motor to recover before repeat crank attempts are made.
●	●	●	Start attempts	<input type="checkbox"/> 3	<input type="checkbox"/> attempts	(1 – 9) Sets the maximum number of crank attempts Autostart makes before signalling a 'start fail' alarm.
●	●	●	Override	<input type="checkbox"/> 15 sec	<input type="checkbox"/> sec	(02 – 59 secs) Immediately after an engine start, this timer may be used to hold off fault shutdowns (e.g. oil pressure) for a further short time.
●	●	●	Speedsig	<input type="checkbox"/> 01 sec	<input type="checkbox"/> sec	(01 – 59 secs) This holds off a 'no speed signal' fault shutdown immediately after engine start, particularly if a 'soft-start' AC alternator is used (where there is initially little or no AC frequency signal).
●	●	●	Warmup	<input type="checkbox"/> 02 sec	<input type="checkbox"/> sec	(00 – 59 secs) In Auto mode, after the engine has started, this timer may be used to delay the operation of a 'gen. contactor' output (i.e. delay the loading of the generator).
●	●	●	Restore	<input type="checkbox"/> 0:03:00	<input type="checkbox"/> hrs min sec	(0 – 1 hour) In Auto mode, after a mains return (or clearing of a 'remote start' condition), this timer sets a delay before Autostart transfers the load from the generator back to the mains AC supply.
●	●	●	Eng.cool	<input type="checkbox"/> 0:03:00	<input checked="" type="checkbox"/> hrs min sec	(0 – 1 hour) In Auto mode, this timer lets the engine run off load before stopping the engine.
●	●	●	Eng 2 stop	<input type="checkbox"/> 5 sec	<input checked="" type="checkbox"/> sec	(05 – 59 secs) Any output set to 'energised to stop' (fuel) output activates as soon as the engine is required to stop; the output de-activates after the engine has stopped and this further time has expired.
●	●	●	Rem test	<input type="checkbox"/> 1 min	<input type="checkbox"/> min	(1 – 240 mins) A engine or generator test run may be initiated from a remote PC over the communications link. Autostart will then run for this time, even if the communication link is broken.
●	●	●	Hours run:	<input checked="" type="checkbox"/> ON	<input type="checkbox"/> OFF	(ON or OFF) Enables or disables the display of the hours run counter.

AS705S AS710S AS730S	Function	Settings (tick as appropriate):		Description
		Default	New	
• • •	CF:	<input type="checkbox"/> not used	<input type="checkbox"/> charge alt. <input type="checkbox"/> mains charge	Sets the operation of the Autostart's 'charge fail' warning (as measured through pin 2):- charge alt: overrides display of any 'charge fail' fault while the engine is at rest, during engine starting and for the duration of the 'override' time. mains charge: allows Autostart to give a charge fail warning at any time (when engine is stationary or running). A charge fail warning will not, however, occur during engine cranking. not used: use this setting to disable the charge fail warning. Leave pin 2 open circuit.
• • •	WL crank cut:	<input type="checkbox"/> -- V	<input type="checkbox"/> V	(1 – 30 VDC, or '– –' if not used) This setting is only available if 'charge alt' option has been selected above, and allows the rising charge alternator WL voltage to be used to trigger the automatic release of the engine starter motor. This feature can be used in addition to, or instead of, the generator AC frequency or magnetic pickup 'crank cut' settings (see below). Typically, this option can be used where the generator AC (50/60Hz) alternator is a 'soft-start' type, with little or no AC output until after the engine is fully running. Autostart releases the starter motor when the charge alternator WL voltage, measured through pin 2, exceeds the programmed setting. If the WL crank release feature is not required, use the -- setting.
• • •	WL chrg fail:	<input type="checkbox"/> 10V	<input type="checkbox"/> V	(1 – 30 V DC) This setting is only available if either the 'charge alt' or 'mains charge' option has been selected above. It sets the voltage level, measured through pin 2, below which Autostart considers a 'charge fail' fault has occurred. For charge alternators, this is typically set at slightly below the nominal battery voltage.
• • •	Battery LO:	<input type="checkbox"/> 10 V	<input type="checkbox"/> V	(10 – 30 V DC) Autostart gives a 'low battery volts' warning if the DC supply falls below this voltage.
• • •	Battery HI:	<input type="checkbox"/> 32 V	<input type="checkbox"/> V	(12 – 35 V DC) Autostart gives a 'high battery volts' warning if the DC supply rises above this voltage.
• • •	AC sense (AC gen fitted?)	<input type="checkbox"/> YES	<input type="checkbox"/> NO	(Yes or No) Sets whether or not the generator AC (50/60Hz) signal is used to sense engine speed. On the AS730S, this setting also enables or disables the generator AC voltage and current sensing.
•	Gen phases	<input type="checkbox"/> 3	<input type="checkbox"/>	(3, 2 or 1) Allows Autostart to be used with 3, 2 or single phase generators (AS730S only).
•	AC display:	<input type="checkbox"/> L-N	<input type="checkbox"/> L-L	(L-N or L-L) AS730S only. Sets whether the Autostart displays 'line to neutral' or 'line to line' voltage, both during normal operation and when programming AC voltage trip levels.

In order to bring you the highest quality, full featured products, we reserve the right to change our specifications and designs at any time.

AS705S AS710S AS730S	Function	Settings (tick as appropriate):		Description
		Default	New	
•	Gen UV trip:	<input type="checkbox"/> 200 V	<input type="checkbox"/> V	(50 – 500 VAC) AS730S only. The AS730S indicates 'gen. under volts' if any of the three AC voltages fall below this set level. The UV level is NOT programmable on the AS705S or 710S, but is pre-set in hardware to around 66% of nominal. The Autostart response to this fault – engine shutdown or load release – is also programmable: see below.
• • •	Gen UV action:	<input type="checkbox"/> RELEASE	<input type="checkbox"/> SHUTDOWN	Sets the response to a generator under voltage condition:- Release: Autostart takes the generator off load, displays 'Gen. Under Volts', but allows the engine to run on. Autostart automatically attempts to reload the generator if the voltage rises to within normal limits (except when an input has been programmed to 'load reset' - see 'programmable inputs' section below). Shutdown: causes immediate unload and shutdown of the generator, and display of 'Gen Under volts'.
•	Gen UV OK:	<input type="checkbox"/> 210 V	<input type="checkbox"/> V	(50 – 500 VAC) AS730S only. This sets the level above which Autostart considers the generator AC voltage is OK. This level is NOT programmable on the AS705S or 710S, but is pre-set in hardware to around 66% of nominal. Autostart never attempts to load the generator unless the AC voltage is above the appropriate (programmed or pre-set hardware) level.
•	Gen OV trip:	<input type="checkbox"/> 500 V	<input type="checkbox"/> V	(50 – 600 VAC) - AS730S only. The AS730S shuts down the generator and indicates GEN OVERVOLTS if any of the three AC voltages rise above this programmed level.
•	CT ratio	<input type="checkbox"/> 1000 : 5 A	<input type="checkbox"/> : 5 A	(10:5 to 5000:5) AS730S only. Autostart measures AC generator current by use of current transformers (with 5 Amp secondary coils). To correctly measure AC current, the CT ratio must be entered here.
•	Full load:	<input type="checkbox"/> 500 A	<input type="checkbox"/> A	(2 to 5000 Amps) AS730S only. Set this to match the full load current rating of the generator. This setting (with the IDMT constant below) sets the overload/trip-time response for the over-current warning and shutdown alarms.
•	IDMT constant	<input type="checkbox"/> 36	<input type="checkbox"/>	(10 to 50) AS730S only. The overload current/trip time curve has an IDMT characteristic, giving a quicker response for large overloads and a slower response for smaller overloads. Higher settings of the IDMT constant result in longer trip times (for a fixed over current level). This setting should be made in consultation with the alternator spec.
•	I trip (xFLC)	<input type="checkbox"/> 3.0	<input type="checkbox"/>	(1.0 – 3.0) AS730S only. Allows a user-programmable maximum current limit, above which Autostart instantly trips out (overriding the IDMT response). The setting is expressed as multiples of the full load current setting (see above).
•	Over I:	<input type="checkbox"/> RELEASE	<input type="checkbox"/> SHUTDOWN	<i>AS730S only.</i> Sets the response to a generator over current condition:- Release: Autostart takes the generator off load, displays 'Gen. Over I', but allows the engine to run on. Autostart will automatically attempt to reload the generator if the current falls to within normal limits (except when an input has been programmed to 'load reset' - see programmable input section below). Shutdown: Autostart immediately unloads and shuts down the generator, and displays 'Gen Over I'.

In order to bring you the highest quality, full featured products, we reserve the right to change our specifications and designs at any time.

AS705S AS710S AS730S	Function	Settings (tick as appropriate):		Description
		Default	New	
• • •	Crank cut:	<input type="checkbox"/> 20 Hz	<input type="checkbox"/> Hz	(5 – 25 Hz.) Sets the AC frequency for engine crank release, when AC is used for speed sensing.
• • •	Undr freq:	<input type="checkbox"/> 45 Hz	<input type="checkbox"/> Hz	(40 – 60 Hz.) Sets the generator under frequency level, when generator AC is used for speed sensing.
• • •	Over freq:	<input type="checkbox"/> 55 Hz	<input type="checkbox"/> Hz	(50 – 70 Hz.) Sets the generator over frequency shutdown trip, when the AC is used for speed sensing.
• • •	Mag pickup	<input type="checkbox"/> NO	<input type="checkbox"/> YES	(YES or NO) Enables or disables engine speed sensing via magnetic pickup.
• • •	MPU teeth:	<input type="checkbox"/> 60	<input type="checkbox"/> teeth	(1 – 250 teeth) When a magnetic pickup is used, enter the number of flywheel teeth.
• • •	Crank cut:	<input type="checkbox"/> 525	<input type="checkbox"/> RPM	(100 – 1500 RPM) Sets the engine crank release speed, when speed is measured by magnetic pickup.
• • •	Undr speed:	<input type="checkbox"/> 1350	<input type="checkbox"/> RPM	(500 – 3550 RPM) Sets the engine underspeed level, when speed is measured by magnetic pickup.
• • •	Over speed:	<input type="checkbox"/> 1650	<input type="checkbox"/> RPM	(1000 – 5400 RPM) Sets the engine overspeed shutdown trip, when measured by magnetic pickup.
• • •	O/S override	<input type="checkbox"/> 0 %	<input type="checkbox"/> %	(0 – 25%) Sets an additional speed overshoot (as percentage of the overspeed level above), permitted immediately after engine start (for 'speed sig. delay).
• • •	U F/RPM:	<input type="checkbox"/> RELEASE	<input type="checkbox"/> SHUTDOWN	<p>Sets the response to a generator under speed/frequency condition:-</p> <p>Release: Autostart takes the generator off load, displays UNDER SPEED/FREQ, but allows the engine to run on. Autostart will automatically attempt to reload the generator if the speed/frequency rises to within normal limits (except when an input has been programmed to 'load reset' - see programmable input section below).</p> <p>Shutdown: Autostart immediately unloads and shuts down the generator, and displays UNDER SPEED/FREQ.</p>
• • •	Load in MAN:	<input type="checkbox"/> NO	<input type="checkbox"/> YES	<p>When running the generator in manual mode, this setting affects whether or not Autostart will attempt to load the generator in response to a remote start (if pin 11 goes open circuit) or mains fail condition:-</p> <p>YES: Autostart activates any 'gen. contactor' output, providing the engine is running within normal limits.</p> <p>NO: the 'gen. contactor' output never operates in manual mode.</p>
•	Remote start	<input type="checkbox"/> OP +VE	<input type="checkbox"/> CL +VE	<i>(AS730S only)</i> Allows the AS730S remote start terminal (pin 11) to be activated by either 'opening from positive' or 'closing to positive' contacts.
• • •	Inputs:	<input type="checkbox"/> close -VE	<input type="checkbox"/> close +VE <input type="checkbox"/> open -VE <input type="checkbox"/> open +VE	<p>For AS705S and AS710SK_B units, this program function sets the 'active' state of switch inputs 1 to 5. The inputs may be set up for remote contacts which open or close when 'active', wired between the input and either +ve or -ve DC.</p> <p>For AS710SK_A and AS730S units, this setting only applies to switch inputs 3 – 5. Analog inputs 1 (oil pressure) and 2 (engine temperature) have individual program options for selection of sender type (see below).</p>

In order to bring you the highest quality, full featured products, we reserve the right to change our specifications and designs at any time.

AS705S AS710S AS730S	Function	Settings (tick as appropriate):		Description
		Default	New	
● ● ●	Input 3 action:	<input type="checkbox"/> +++not used+++	<input type="checkbox"/> Shut: override <input type="checkbox"/> Shut: no override <input type="checkbox"/> Warn: override <input type="checkbox"/> Warn: no override <input type="checkbox"/> Disp: override <input type="checkbox"/> Disp: no override <input type="checkbox"/> Load release <input type="checkbox"/> Lamp test <input type="checkbox"/> Manual restore <input type="checkbox"/> Test OFF load <input type="checkbox"/> Alarm mute <input type="checkbox"/> Load reset <input type="checkbox"/> Remote mode control	<p>Sets the 'action' which Autostart takes when input 3 is made active:-</p> <p>+++not used+++: use this selection when the input is not used. The input may then be left open circuit.</p> <p>Shutdown: override: used with remote fault sensor contacts to trigger a shutdown of the generator. An active input will only trigger a response if the engine is running and the fault override timer has expired. Typical uses: generator under voltage.</p> <p>Shutdown: no override: similar to the above, but an active input will trigger a shutdown response at ANY time (whether the engine stationary, starting or running). Typical uses: fire, coolant loss, earth fault.</p> <p>Warning: override: used with remote fault contacts to trigger a fault warning (but not an engine shutdown). An active input will only trigger a response if the engine is running and the fault override time has expired. Typical uses: general pre-alarms, e.g. engine/alternator temperature warnings, over-current warning</p> <p>Warning: no override: similar to the above, but an active input will trigger a warning at ANY time. Typical uses: low/high fuel level, low ambient temperature.</p> <p>Display: override: may be used to display a status message, without activation of any alarm or warning outputs. The an active input will only trigger a message if the engine is running and the override time has expired. Typical uses: 'generator volts OK', 'full load'.</p> <p>Display: no override: used to trigger a display message, like the above, but the input may be activated at any time. Typical use: 'battery charger boost', 'mains available'.</p> <p>Load release: Autostart de-activates any 'gen. contactor' output and displays a 16 character message. This action is non-latching: unless another input has been programmed to 'load reset' (see below), Autostart will attempt to reload the generator when the 'load release' input clears.</p> <p>Lamp Test: Autostart displays LAMP TEST, lights both Auto and Manual mode LEDs and activates any output programmed to lamp test.</p> <p>Manual restore: (AMF applications) an active input will indefinitely inhibit an automatic load transfer back to the mains after a mains return.</p> <p>Test off load: triggers an engine/generator start and run off load (display says 'TEST').</p> <p>Alarm mute: used to turn off any 'alarm (muteable)' output, without affecting indication of fault.</p> <p>Load reset: permits an operator-controlled re-activation of a 'gen. contactor' output once the Autostart has automatically taken the generator off load (e.g. because of a low frequency trip). Autostart only attempts to re-activate the 'gen.contactor' output when the 'load reset' input is made active, providing that the generator is running within normal limits.</p> <p>Remote Mode Control: AS730 only. Allows Auto or Manual operating mode to be remotely selected. An active input causes the unit to adopt manual mode; an inactive input causes the unit to default to Auto mode. When this option is selected, the front facia MODE key is disabled.</p>
● ● ●	Input 3 message	<input type="checkbox"/> INPUT 3	<input type="checkbox"/>	<p>This 16 character fault or warning message is programmed when input 3 has been set with certain 'actions' above. Whenever the input is activated, this programmed message is then displayed (on the LCD for AS710S and AS730S units, or on the PC monitoring screen for the AS705S). To change the message, use the ▷ key to select each character position (indicated by the underlining cursor), and the △ and ▽ keys to amend each character's letter or number. Press the ↵ key to enter when the full, correct message is displayed.</p>

AS705S AS710S AS730S	Function	Settings (tick as appropriate):		Description
		Default	New	
● ● ●	Input 4 action	<input type="checkbox"/> +++not used+++	<input type="checkbox"/>	Sets the type of 'action' for input 4 (programming as for input 3 above).
● ● ●	Input 4 message	<input type="checkbox"/> INPUT 4	<input type="checkbox"/>	Sets a 16 character message for input 4 (programming as for input 3 above).
● ● ●	Input 5 action	<input type="checkbox"/> +++not used+++	<input type="checkbox"/>	Sets the type of 'action' for input 5 (programming as for input 3 above).
● ● ●	Input 5 message	<input type="checkbox"/> INPUT 5	<input type="checkbox"/>	Sets a 16 character message for input 5 (similar programming to input 3 above).
● ●	LOP sensor	<input type="checkbox"/> LOP:swch clos-VE	<input type="checkbox"/> LOP:swch open-VE <input type="checkbox"/> LOP:analogDATCON <input type="checkbox"/> LOP:analogMURPHY <input type="checkbox"/> LOP:analog VDO 7 <input type="checkbox"/> LOP:analog VDO 5	<i>(AS730S and AS710SK_A only)</i> Sets up the oil pressure input (pin 16) for use with one of several sensor types. Options are available for both switch type sensors (opening or closing on fault) and analogue (resistive) senders (including Murphy, Datcon, VDO 5 bar and VDO 7 bar). The pressure sender unit (whether switch or analogue) is connected between pin 16 and -ve DC. This program feature is not available on AS705S and AS710SK_B units, where the low oil pressure input switch polarity is set as part of 'inputs' programming (see above).
● ●	Oil pressure:	<input type="checkbox"/> psi	<input type="checkbox"/> bar	(PSI or Bar) This and the two screens below only appear when an 'analogue' sender option is selected above. Use this screen to select the measurement units for displaying oil pressure and programming warning/shutdown trip levels: PSI (Pounds per Square Inch) or Bar (i.e. 'atmospheres').
● ●	LOP shut:	<input type="checkbox"/> 12 psi	<input type="checkbox"/> psi/bar	(10–100 PSI, or 0.6–6.9 Bar) If the actual oil pressure falls below this setting, Autostart shuts down the engine and displays 'low oil pressure'.
● ●	LOP warn:	<input type="checkbox"/> 18 psi	<input type="checkbox"/> psi/bar	(10–100 PSI, or 0.6–6.9 Bar) If the actual oil pressure falls below this setting, Autostart gives a 'low oil pressure' warning, but allows the engine to run on.
● ●	HET sensor	<input type="checkbox"/> HET:swch clos-VE	<input type="checkbox"/> HET:swch open-VE <input type="checkbox"/> HET:analogDATCON <input type="checkbox"/> HET:analogMURPHY <input type="checkbox"/> HET:analog VDO	<i>(AS730S and AS710SK_A only)</i> Sets up the engine temperature input (pin 17) for use with one of several sensor types. Options are available for both switch type sensors (opening or closing on fault) and analogue (resistive) senders (including Murphy, VDO, Datcon and BMI). The temperature sender unit (whether switch or analogue) is connected between pin 17 and -ve DC. This program feature is not available on AS705S and AS710SK_B units, where the high engine temperature input switch polarity is set as part of 'inputs' programming (see above).
● ●	Eng temp in:	<input type="checkbox"/> °C	<input type="checkbox"/> °F	(°C or °F) This and the two screens below only appear when an 'analogue' sender option is selected above. Use this screen to select the measurement units (Celcius or Fahrenheit) for displaying engine temperature and programming warning and shutdown trip levels.
● ●	HET shut:	<input type="checkbox"/> 106 °C	<input type="checkbox"/> °C / °F	(80–140 °C, or 176–284°F) If the actual engine temperature rises above this setting, Autostart shuts down the engine, displays 'high engine temp' and activates any appropriate alarm outputs.
● ●	HET warn:	<input type="checkbox"/> 102 °C	<input type="checkbox"/> °C / °F	(80–140 °C, or 176–284°F) Similar to above, except that Autostart only gives an engine temperature warning message, and allows the engine to run on.

AS705S AS710S AS730S	Function	Settings (tick as appropriate):		Description
		Default	New	
• • •	Prog output 1:	<input type="checkbox"/>	++not used++ <input type="checkbox"/>	<p>Sets the function of programmable output 1 (pin 6). Over 40 different options are available:-</p> <p><u>Status and timing functions:-</u></p> <p>Auto mode Output active when Autostart is in AUTO mode. Manual mode Output active when Autostart is in MANUAL mode. Auto or Man mode Output active when Autostart is in Auto or Manual modes. Start warning Output active during the start and preheat delays, to warn of an engine start. Engine active Output activates while the fuel relay is on, i.e. during starting and running. Engine running Output active when the engine is running above the crank release speed. Ext. alarm enable Used to enable or inhibit remote alarm circuits or annunciators. The output activates at the end of the fault 'override' time, and de-activates when the engine is stopped. Gen available Output active when engine is running within voltage, freq. and oil pressure limits. Engine cooling Output active during the engine 'cooling' time.</p> <p><u>Control functions:-</u></p> <p>Preheat mode 1 Used to control engine pre-heater circuits. Output active for preheat time only. Preheat mode 2 As above, but with output active during the preheat and engine crank times. Preheat mode 3 As above, but with output active for preheat, crank and fault override times. Preheat mode 4 As above, but with output active for preheat, crank and warm-up times. Energise to stop Used for the control of Energised to Stop (ETS) type fuel solenoids. Output activates when the engine is required to stop, and de-activates following an engine stop and a expiry of the 'energised to stop' time. Gen contactor Used to allow control a generator contactor coil, allowing Autostart to load/unload the generator. Field flashing May be used to control excitation of AC alternator field windings. Output activates at crank release and de-activates when Autostart senses AC volts. Louvre control Used to control engine enclosure louvres. Output activates at the end of the start delay, and de-activates when the engine is stopped. Charger isolate Used to isolate/connect a mains charger, using normally closed contacts of a connected slave relay. The output activates (isolating the charger) while the generator fuel is on. Lamp test Output activates for a few seconds during power up, when the Autostart carries out an automatic lamp test cycle, or when a Lamp test input is active. PC cntl A mode 1/2 Output activates when communication to remote PC is in progress and PC F5 key is pressed. The output will toggle on and off with each press of the PC F5 key. When the communication link is broken, the type 1 output always switches off, whereas the type 2 output remains in its current state. PC cntl B mode 1/2 As above, but output is activated by pressing PC keyboard F6 key. Rem test on load Output activates during a remote (PC initiated) Autostart test. This output can be used to isolate the mains supply and ensure an on-load test of the generator.</p> <p><u>Fault functions:-</u></p> <p>Common alarm Output activates during all faults (shutdown or warning). Alarm(muteable) As common alarm, but output may be turned off by use of an 'Alarm mute' input. Shutdown fault Output activates after a shutdown fault, and de-activates when Autostart is reset. Warning fault Output activates during a warning fault, and de-activates when the fault clears. Individual faults Output actions for the remote signalling of individual faults:- Start fail, Overspeed/Freq, Under speed/freq., Gen under volts, Gen over volts, HI current warn (AS730S only), HI current shut (AS730S only), Gen out Limits, No speed signal, Mag.pickup fail, Emergency Stop, LOP shutdown, LOP warning, HET shutdown, HET warning, Input 3, Input 4, Input 5, Charge Fail, Battery Volts Low, Battery Volts High, Battery Volts fault</p>

AS705S AS710S AS730S	Function	Settings (tick as appropriate):		Description
		Default	New	
● ● ●	Prog output 2:	<input type="checkbox"/> +++not used+++	<input type="checkbox"/>	Sets the function of programmable output 2 (pin 7). Program options as for output 1 above.
● ● ●	Prog output 3:	<input type="checkbox"/> +++not used+++	<input type="checkbox"/>	Sets the function of programmable output 3 (pin 9). Program options as for output 1 above.
● ● ●	Prog output 4:	<input type="checkbox"/> +++not used+++	<input type="checkbox"/>	Sets the function of programmable output 4 (pin 10). Program options as for output 1 above.
● ● ●	Prog output 5:	<input type="checkbox"/> Common alarm	<input type="checkbox"/>	Sets the function of programmable output 5 (pin 24). This output is normally used as a 'common alarm' output for remote signalling of fault conditions, but may be re-programmed if necessary with 'actions' as for outputs 1 - 4.
● ● ●	Prog output 6:	<input type="checkbox"/> Gen contactor	<input type="checkbox"/>	Sets the function of programmable output 6 (pins 25 and 26). This output is normally used to control the generator contactor coil circuit, but may be re-programmed if necessary with 'actions' as for outputs 1 - 5.
● ●	Site name:	<input type="checkbox"/> Murphy UK 001	<input type="checkbox"/>	Allows the setting of a unique site name, for use as an identifier during remote communication.
● ●	Phone out if:	<input type="checkbox"/> Never	<input type="checkbox"/> Shutdown only <input type="checkbox"/> Warn or Shutdown	Sets the conditions for which Autostart automatically dials out and establishes communications with a remote PC. A 'Warn or Shutdown' option also causes an automatic dial out in the event of a remote start/mains fail condition.
● ●	Phone-out number	<input type="checkbox"/> none	<input type="checkbox"/>	Sets the telephone number (for the modem and PC) that Autostart dials when the above condition be met. This screen is not displayed if the above is set to 'never'.
● ●	Power-up message	<input type="checkbox"/> **Murphy**	<input type="checkbox"/>	Sets a 16 character message, displayed whenever the unit is powered up.
●	Switch on PIN	<input type="checkbox"/> (0000)	<input type="checkbox"/>	(0000 – 9999) AS730S only: this PIN may be used to prevent unauthorised control of the Autostart and generator. After the AS730S is powered up (by pressing the On/mode button), the user must enter a correct Personal Identification Number (PIN) before any control of the generator (automatic or manual) is permitted. A setting of 0000 gives unrestricted access. On the AS710S, mode control is restricted by a keyswitch – the key may be removed in Off and Auto modes.
● ●	Program mode PIN	<input type="checkbox"/> (1234)	<input type="checkbox"/>	(0000 – 9999) This PIN may be used to restrict 'program mode' access. A setting of 0000 gives unrestricted access. Note that this PIN does not restrict program mode access over a communications link, which is covered by the 'Remote log on PIN' (see below).
● ●	Remote Log-on PIN	<input type="checkbox"/> (5678)	<input type="checkbox"/>	(0000 – 9999) This PIN may be used to prevent unauthorised communication from a modem/PC to an Autostart. An Autostart with a 0000 setting will give unrestricted remote access to monitoring, control and programming.
●	Mode change PIN	<input type="checkbox"/> (0000)	<input type="checkbox"/>	(0000 – 9999) On the AS730S, the mode change PIN setting may be used to prevent unauthorised switching between Auto and Manual modes. A setting of 0000 gives unrestricted mode changes. On the AS710S, mode control is restricted by a keyswitch – the key may be removed in Off and Auto modes.
●	Sw off delay:	<input type="checkbox"/> NO	<input type="checkbox"/> YES	(YES or NO) On the AS730S, this PIN may be used to inhibit an accidental or unauthorised switch off of the unit. When a YES setting is made, the AS730S will only power down by pressing and holding the front facia OFF button for approximately 10 seconds.
● ●	Store changes?			(AS710S and AS730S only). This screen appears once all the programmable settings have been stepped through. Select YES to store the changes and exit program mode, or NO to return to 'start delay' and step through the program settings again.

In order to bring you the highest quality, full featured products, we reserve the right to change our specifications and designs at any time.

AS705S AS710S AS730S	Function	Settings (tick as appropriate):		Description
		Default	New	
●	Prog LED 1:	<input type="checkbox"/> +++not used+++	<input type="checkbox"/>	<p><i>AS705S only.</i> Programmable LEDs 1 – 5 are on the right-hand side of the front facia. These LEDs can be programmed to indicate a range of status or fault conditions; a pocket in the front label allows for custom labelling of these LEDs. LED1 is amber in colour. The programmable options are:-</p> <p><u>Status and timing functions:-</u> LEDs light to indicate Autostart or plant status. Options are:- Fuel on, engine cranking, fault holdoff, engine warmup, restore delay, engine cooling, Gen volts OK, Gen available, Gen. On load, Mains on Load, Start demand, Engine running.</p> <p><u>Inputs/outputs:-</u> LED's light to indicate an active input or output. Depending on the input or output configuration, each LED can be used to indicate a wide range of status/fault conditions (e.g. preheat, manual restoration, warning fault, etc). Options are:- Input 3, Input 3 (flashing), Input 4, Input 4 (flashing), Input 5, Input 5 (flashing), Prog. Output 1, Prog. Output 2, Prog. Output 3, Prog. Output 4, Prog. Output 5, Prog. Output 6.</p> <p><u>Fault functions:-</u> 'Common alarm' LED lights during all faults (shutdown or warning). Other fault functions cause LED to light during a particular fault. LED typically flashes for a 'warning' type fault and is lit continuously for a 'shutdown' fault. Individual fault options are:- Batt. Volts Low, Batt. Volts High, Batt. Volts Fault, No Speed Signal, Bad Oil Pressure, Gen. Under Volts, Mag. Pickup Failure, Start Fail, LOP (Low Oil Pressure) shutdown, HET (High Engine Temperature) shutdown, Overspeed, Underspeed, Charge Fail, Emergency Stop.</p>
●	Prog LED 2:	<input type="checkbox"/> +++not used+++	<input type="checkbox"/>	LED 2 (amber). Similar programming/operation to LED1 above.
●	Prog LED 3:	<input type="checkbox"/> +++not used+++	<input type="checkbox"/>	LED 3 (red). Similar programming/operation to LED1 above.
●	Prog LED 4:	<input type="checkbox"/> +++not used+++	<input type="checkbox"/>	LED 4 (red). Similar in programming/operation to LED1 above.
●	Prog LED 5:	<input type="checkbox"/> +++not used+++	<input type="checkbox"/>	LED 5 (red). Similar programming/operation to LED1 above.
●	Prog LED A:	<input type="checkbox"/> Start demand	<input type="checkbox"/>	<p><i>AS705S only.</i> Programmable LEDs A – J are on the left hand side of the AS705S front facia, with default settings that reflect the standard labelling. These LEDs can, however, be reprogrammed with the same range of options as LEDs 1 to 5 above (e.g. when a custom front label is fitted). Programmable LED A is amber in colour.</p>
●	Prog LED B:	<input type="checkbox"/> Engine running	<input type="checkbox"/>	LED B (amber). Similar programming/operation to LED1 above.
●	Prog LED C:	<input type="checkbox"/> Start fail	<input type="checkbox"/>	LED C (red). Similar programming/operation to LED1 above.
●	Prog LED D:	<input type="checkbox"/> Low oil pressure	<input type="checkbox"/>	LED D (red). Similar programming/operation to LED1 above.
●	Prog LED E:	<input type="checkbox"/> High engine temp	<input type="checkbox"/>	LED E (red). Similar programming/operation to LED1 above.
●	Prog LED F:	<input type="checkbox"/> Overspeed	<input type="checkbox"/>	LED F (red). Similar programming/operation to LED1 above.
●	Prog LED G:	<input type="checkbox"/> Underspeed	<input type="checkbox"/>	LED G (red). Similar programming/operation to LED1 above.
●	Prog LED H:	<input type="checkbox"/> Charge fail	<input type="checkbox"/>	LED H (red). Similar programming/operation to LED1 above.
●	Prog LED I:	<input type="checkbox"/> Common alarm	<input type="checkbox"/>	LED I (red). Similar programming/operation to LED1 above.
●	Prog LED J:	<input type="checkbox"/> Emergency stop	<input type="checkbox"/>	LED J (red). Similar programming/operation to LED1 above.

PHASE OUT / DISCONTINUED
Check Availability

FW MURPHY

P.O. Box 470248, Tulsa, Oklahoma 74147 USA
+1 918 317 4100 Fax: +1 918 317 4266
E-mail: sales@fwmurphy.com

INDUSTRIAL PANEL DIVISION

Fax: +1 918 317 4124
E-mail: ipdsales@fwmurphy.com

MURPHY POWER IGNITION

Website: www.murphy-pi.com

CONTROL SYSTEMS AND SERVICES DIVISION

P.O. Box 1819, Rosenberg, Texas 77471 USA
Phone: +1 281 633 4500 Fax: +1 281 633 4588
E-mail: cssolutions@fwmurphy.com

FRANK W. MURPHY LTD.

Church Road, Laverstock,
Salisbury, SP1 1GZ, United Kingdom
Tel: +44 1722 410055
Fax: +44 1722 410088
E-mail: sales@fwmurphy.co.uk
Web: www.fwmurphy.co.uk

COMPUTRONIC CONTROLS

41 - 46 Railway Terrace, Nechells,
Birmingham, B7 5NG, United Kingdom
E-mail: sales@computroniccontrols.com
Web: www.computroniccontrols.com

FW MURPHY INSTRUMENTS (HANGZHOU) CO., LTD.

77 23rd Street, Hangzhou Economic & Technological Development Area
Hangzhou, Zhejiang, 310018, China
Phone: +86 571 8788 6060 Fax: +86 571 8684 8878
E-mail: apsales@fwmurphy.com



USA-ISO 9001:2008 FM 28221
UK-ISO 9001:2008 FM 29422
CHINA-ISO 9001:2008 FM 523851
Registered Facilities

ISO 9001
REGISTERED